

- Legend**
- Application Site (2.3 ha) Outlined in Red
 - Lands in the Ownership of the Applicant and/or Landowner

00_OS Map
1:1000

Site Location Map

OS MAP SERIES: 1:1000
 OS MAP REF: 3264-02
 ITM Centre Point Co-ordinate: X,Y = 717768,734900
 Copyright Ordnance Survey Ireland and Government of Ireland

**Ordnance Survey Ireland
 License No. AR 0005018**

OS sheet 3264-02, 3198-22, 3198-23, 3264-03:

REVISION DATE = 30-Mar-2016
 SURVEY DATE = 31-Dec-1970
 LEVELED DATE = 31-Dec-1983

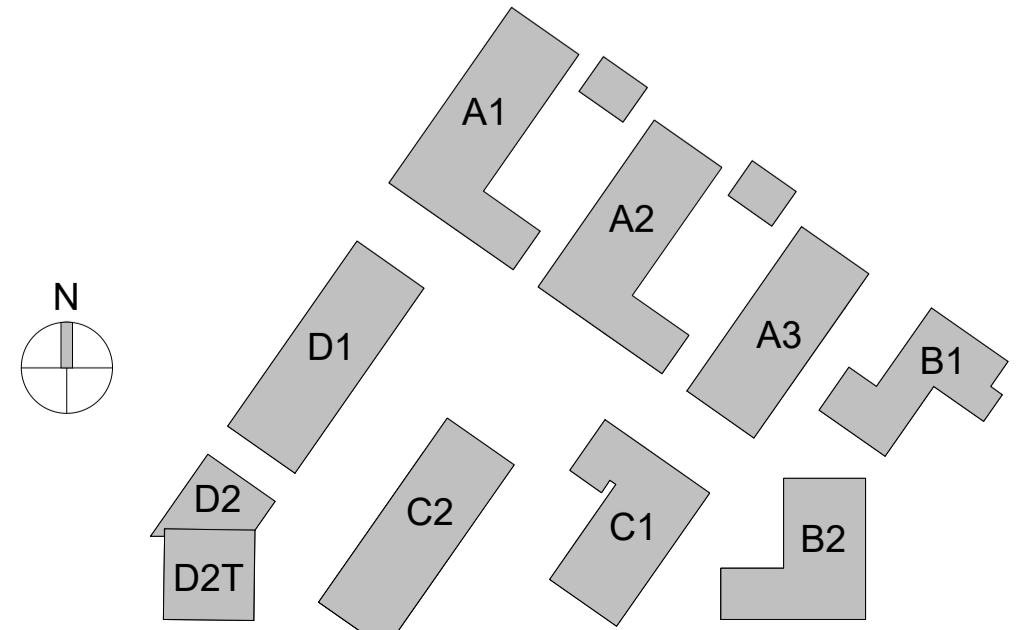

Revision Description	Date	Rev. No.	Issued by
SHD Lodgment to ABP	24-04-2019	1	JS/ES

omahony pike

architecture | urban design
 email: info@omahonypike.com
 tel: +353 1 202 7400
 fax: +353 1 283 0822
 www.omahonypike.com

Dublin
 The Chapel
 Mount St. Anne's
 Milltown, Dublin 6
 D06 XN52 Ireland

Cork
 26 South Mall
 Cork City
 Co. Cork
 T12 R2RV Ireland

Project No.: 1804
Project Lead: DM
Drawn By: JS/ES
Model No.: 1804-OMP-ZZ-ZZ-M3-A-XX-00001
Purpose: Planning

Scale @ A1: 1 : 1000
Date Printed: 24-04-2019
Current Rev.: 1

Project: East Rd SHD
Location: East Wall, Dublin 3
Client: Glenveagh Living Ltd.

Drawing Title: Site Location Map
Drawing No.: 1804-OMP-00-00-DR-A-XX-11000

Figured dimensions only to be used. This drawing is copyright of O'Mahony Pike Architects Ltd. All information is shared as per approved use in accordance with BS1192(2007) + A2(2016), Table 5; Standard Codes for Suitability of Models and Documents. If 'Information Approval Check' is empty, this information has been shared at 50 - WIP.